

# Lauwin-Planque - Construction of a roundabout on the RN 43

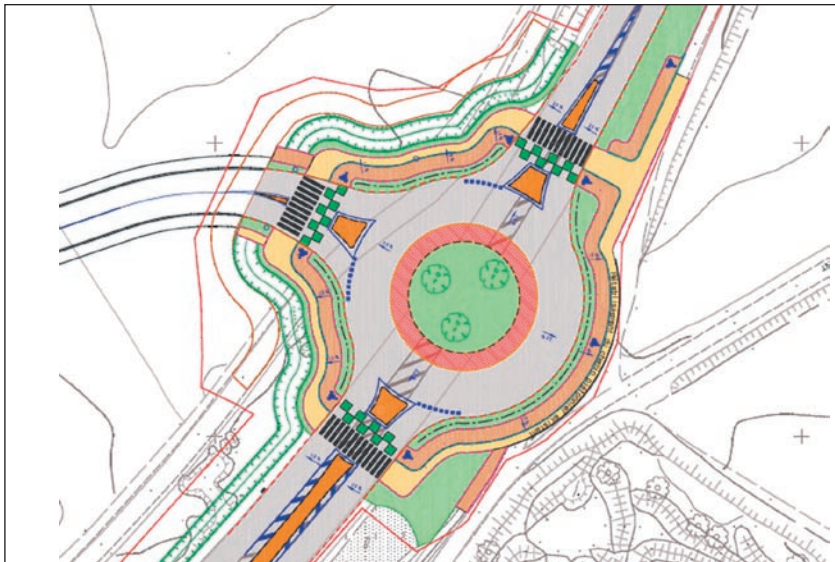

## Country

France

## Client

Communauté  
d'Agglomération du Douaisis

## Date

2005-2007

## Cost of works

€350,000 exc. VAT

## Sogreah's services

- ◆ Design services and project supervision

## Description

The project includes the construction of a 40 m diameter roundabout on the RN 43 road in the commune of Flers-les-Douai, with a view to serving the future 105 ha logistics area at Lauwin-Planque.

A pedestrian footpath and cycle track are also included in the scheme.

Particular attention was paid to landscaping and environmental integration aspects and to the environmental quality of the works. For this reason, wooden fences replace the traditional metal crash barriers and drainage is provided along the cycle tracks and footpaths. In addition, the asphalt used for the footpaths has a plant-based binder.

## Characteristics

### Roads

- ◆ Road structure
  - Class 5 anti-contaminant geotextile.
  - Road bed made of natural gravel.
  - Sub-base made of class 3 bituminous gravel.
  - Base course made of class 3 bituminous gravel.
  - Surface of semi-granular bituminous concrete.
- ◆ Footpath structure
  - Natural gravel layer.
  - Curing coating.
  - Coloured 0/6 porous limestone asphalt with plant-based binder.
- ◆ Cycle track structure
  - Natural gravel layer.
  - Curing coating.
  - 0/6 porous limestone asphalt.

## Utility networks

- ◆ Stormwater
  - Runoff is collected in catch basins of the Adopta type (settlement with honeycomb type filter) before being discharged into the existing networks (ditch or drain).
- ◆ Lighting
  - Construction of the roundabout involved installing a low voltage network in order to supply the lighting, which consists of 9 m high masts. Specific lighting for the pedestrian crossings was also provided by low-angled lighting masts.

## Green spaces

Green spaces are turfed.

GNB/CDE/ebd/0607